

TECHNICAL INFORMATION
COLONIAL HALL
VIRGINIA TECH CAMPUS
Blacksburg, Virginia
Office: 540-231-3499
Email: production@vt.edu
Version Date: February 22, 2018

Virginia Tech does not discriminate against employees, students, or applicants on the basis of age, color, disability, gender, gender identity, gender expression, national origin, political affiliation, race, religion, sexual orientation, genetic information, or veteran status; or otherwise discriminate against employees or applicants who inquire about, discuss, or disclose their compensation or the compensation of other employees, or applicants; or any other basis protected by law.

Table of Contents

General Information	page 3
Directions to venue	page 4
Management information	page 4-5
Load-in area	page 5

Department Sections:

Carpentry	page 6
Lighting	page 7
Sound	page 7
Video	page 7
Wardrobe	page 7

Attached Diagrams:

Venue Seating	page 8
Venue Layout	page 9
Stage Layout	page 10

TECHNICAL SERVICES

SECL Production Services
321 Squires Student Cent.
Blacksburg, VA 24061
Vox: (540) 231-3499
Email: production@vt.edu

GENERAL INFORMATION

Area Hotels:

There are a variety of local hotels, please contact the Presenter for this information.

Taxi Services:

There are a limited number of Taxi Services in the area, please contact the Presenter for this information.

Restaurants:

There is a wide variety of food in walking distance, including fast food, sandwich shops, delis, vegetarian, Chinese and other interests. Please contact the Presenter for more specific information.

Handicapped Access:

The Handicapped seating is at the front of the auditorium.

Emergency Numbers:

All emergency Services: 911 (from campus phone)
University Police/Dispatcher: 540-231-6411
Hospital Emergency Room: 540-953-5122
If additional numbers are needed, please contact the presenter.

Parking:

Must be worked out with presenter in advance

Laundry:

Offsite facility, about 1 mile away with coin operated machines.

Shipping:

If you need to have a package sent to you while in this venue, make arrangements with the local presenter. The local production staff will not receive packages on behalf of a show.

Directions to Venue:

To reach the campus from Interstate 81 (southbound and northbound:

- Take Exit 118, which has ramps to several different Christiansburg and Blacksburg exits. Take Exit **118B** onto U.S. 460 West; this ramp connects directly to the Christiansburg Bypass. Follow the signs for Blacksburg/Virginia Tech.
- Turn **right** at the stoplight at the intersection of 460W and Southgate Drive.
- Take the **second left** onto Spring Road.
- Take the right onto Washington Street. (You will be at the end of Spring Road.)
- Take the second left onto Kent Road
- At the top of the hill. Take the first right onto Alumni Mall.
- **“Receiving Dock B” will be on your right side.**

Geographical Coordinates:

- Latitude: 37.2302
- Longitude: -80.4177

Time Zone:

Eastern

MANAGEMENT

SECL Production Services
321 Squires Student Cent.
Blacksburg, VA 24061
Vox: (540) 231-3499
Email: production@vt.edu

Office Hours: 10am-6pm Monday-Friday (Eastern Time)

*The local staff offices are not in this venue

Tour Production Office:

Please arrange needs with local presenter

Green Room:

The Green Room is located Stage Right

Stage Managers Console:

There is no Stage Manager's console for this venue.

Rehearsal Rooms:

There are no rehearsal rooms for this venue. Please work out alternate arrangements with the presenter.

Crew:

Trained student crew and volunteer students

The Presenter supplies the majority of the labor using volunteer student staff.

Handicapped Access to the Stage:

Handicapped Access should be discussed ahead of time

Policies: (listed policies are non-negotiable)

- This venue is a non-smoking venue, and alcohol is not to be served at any events in this venue.
- There is a performance curfew 30 minutes prior to building close. This varies depending on the day of the week. (M-TH: 11pm) (F-Sat: 12am) (Sun: 10pm)
- The Virginia Tech Police have the authority to be anywhere in the venue at any time.
- Any use of any pyrotechnics, smoke machines, fog machines, open flames or other similar environmental/pyrotechnic is prohibited in this hall.

LOAD-IN AREA

- ***Trucks and busses must not block emergency service vehicles Access to the building, or block exits from the building needed for fire egress.***
- Any truck or bus that is left to park in the loading area, must have a driver that is immediately accessible by phone or radio to move the vehicle in case of an emergency.
- Measurements (listed from the exterior of the building moving toward interior)
 - Loading Dock A
 - Ground Level
 - Double Door
 - 9'-0" high x 8'-0"

CARPENTRY

Seating:

- Before production kills, the seating capacity is 403
- After production kills the seating capacity is 391
- Handicap seating is available in front of main seats
See attached seating diagram on page 8

Stage Dimensions:

Forum Style Hall
Designated stage space
See attached seating diagram on page 9

Stage Height:

Ceiling Height 12'0" over stage

Stage Floor:

The Stage floor is carpeted

Support Areas:

Green Room:

SR Wing. Capacity 10

Dressing room:

Connected to Green room and hallway. There is a mirror and a sink. Capacity: 3

Storage:

There is no storage available for this venue.

LIGHTING

Theatrical system with a white wash.

Architectural:

4 Zones of dimmable incandescent.

6 zones of metal halides

4 Zones of auxiliary lights-fluorescent.

The Dimmable incandescent and metal halides SHOULD NOT be on simultaneously

Stage:

16 2.4K dimmable circuits in coves.

Controlled by QLab 4 in sound booth

SOUND

Full distributed system-Booth at rear of house

Speakers:

83 coaxial speakers

QSC I282

Control:

8 Channel Behringer X-Touch remotes to a Behringer X32 rack mounted mix rack

Full patch bay.

Additional equipment available upon request.

Video:

Epson video/computer projector

Stage pocket available SL with video/computer inputs and power

12'H x 18'W Dalite motorized screen

Intercom:

Available upon request

WARDROBE

All Wardrobe issues are between the show and the presenter

Laundry facilities are off campus, about 1 mile and are coin operated.

No Wardrobe facilities are available in this venue.

Seating Layout

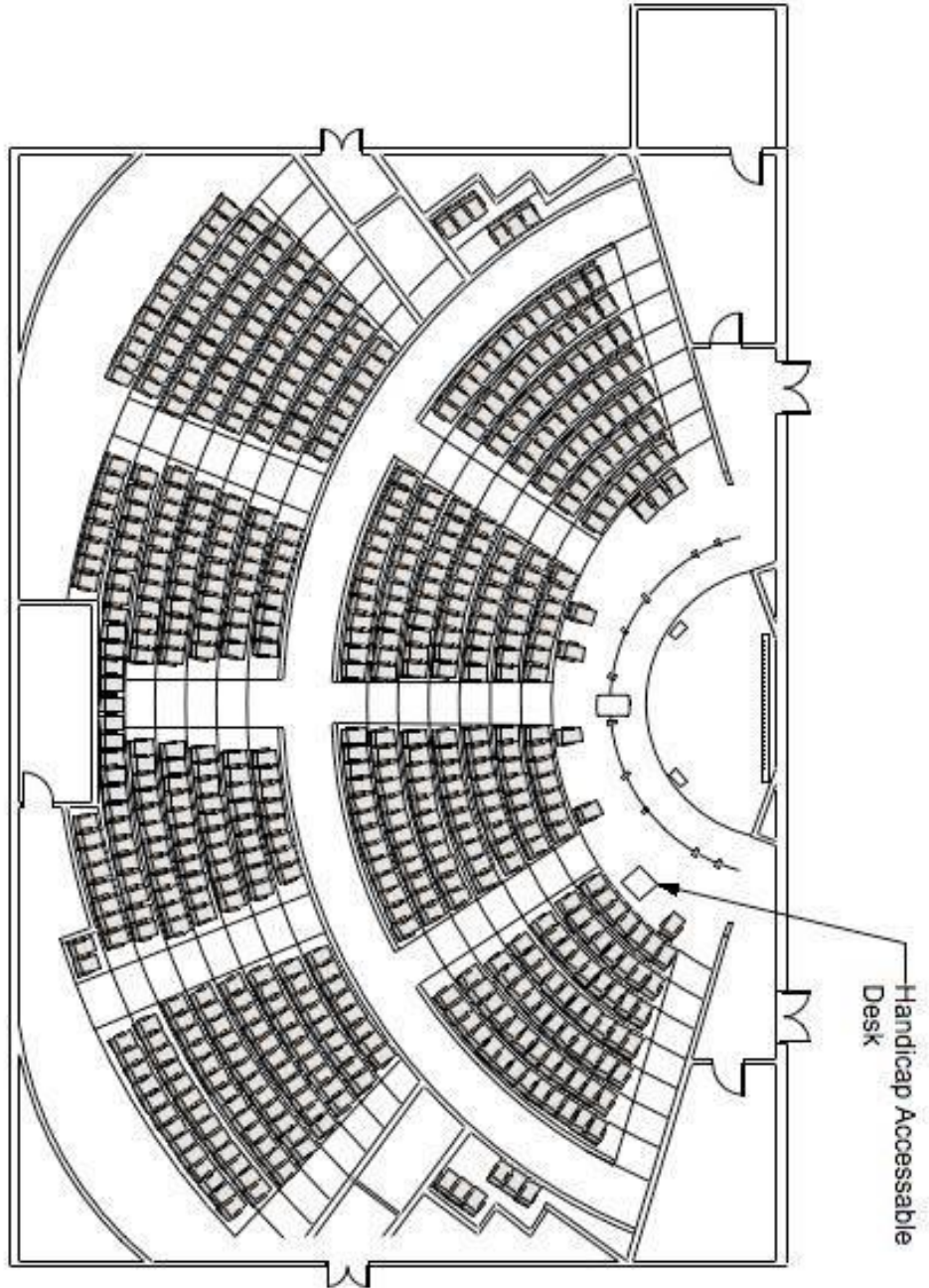

VIRGINIA TECH PRODUCTION SERVICES	
COLONIAL HALL	
SEATING LAYOUT	
DRAFTED BY: WEST LIVINGSTON	PLATE: 1
DATE: 10/08/17	SCALE: 3/16" = 1'-0"
	OF 1

Venue Layout

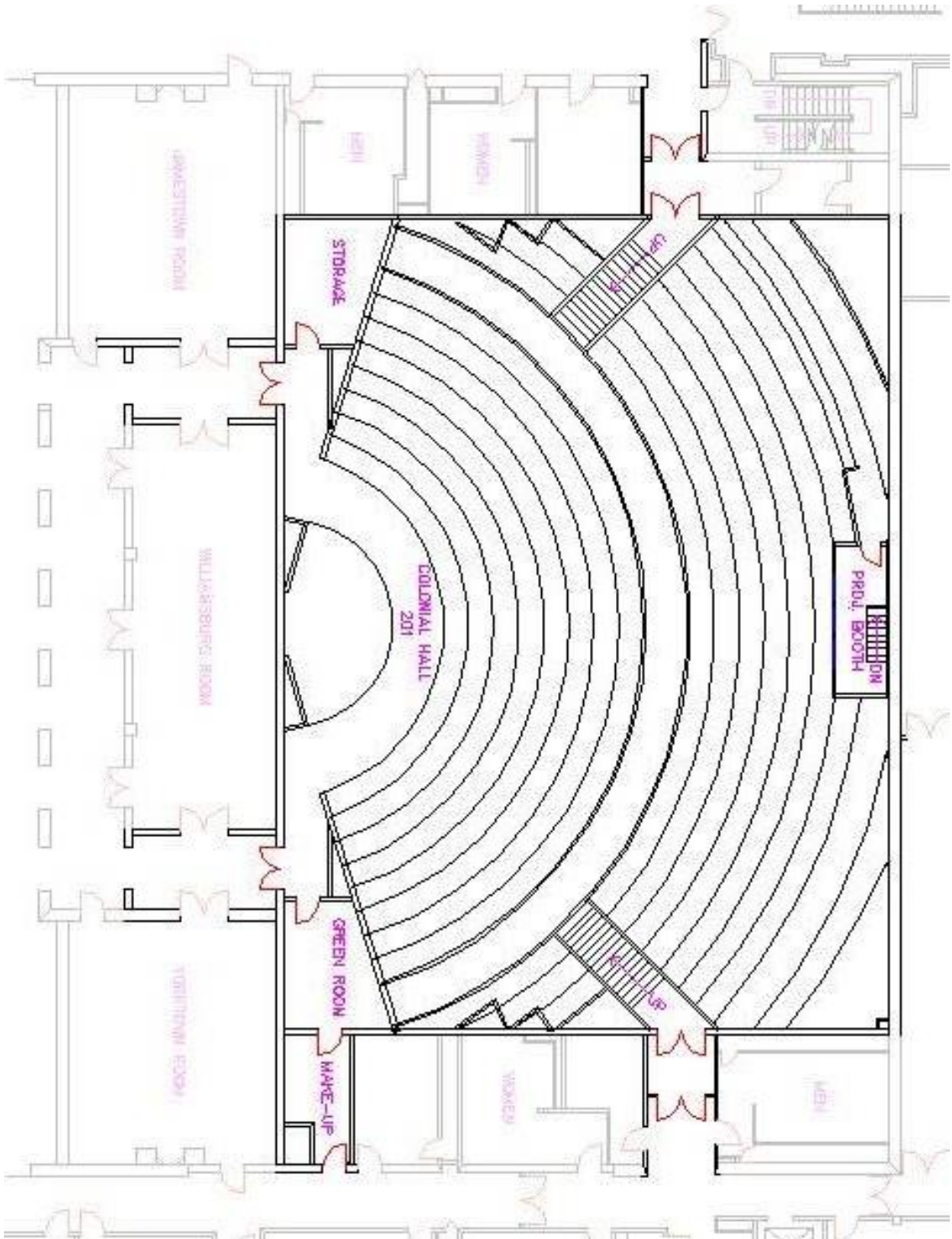

Stage Layout

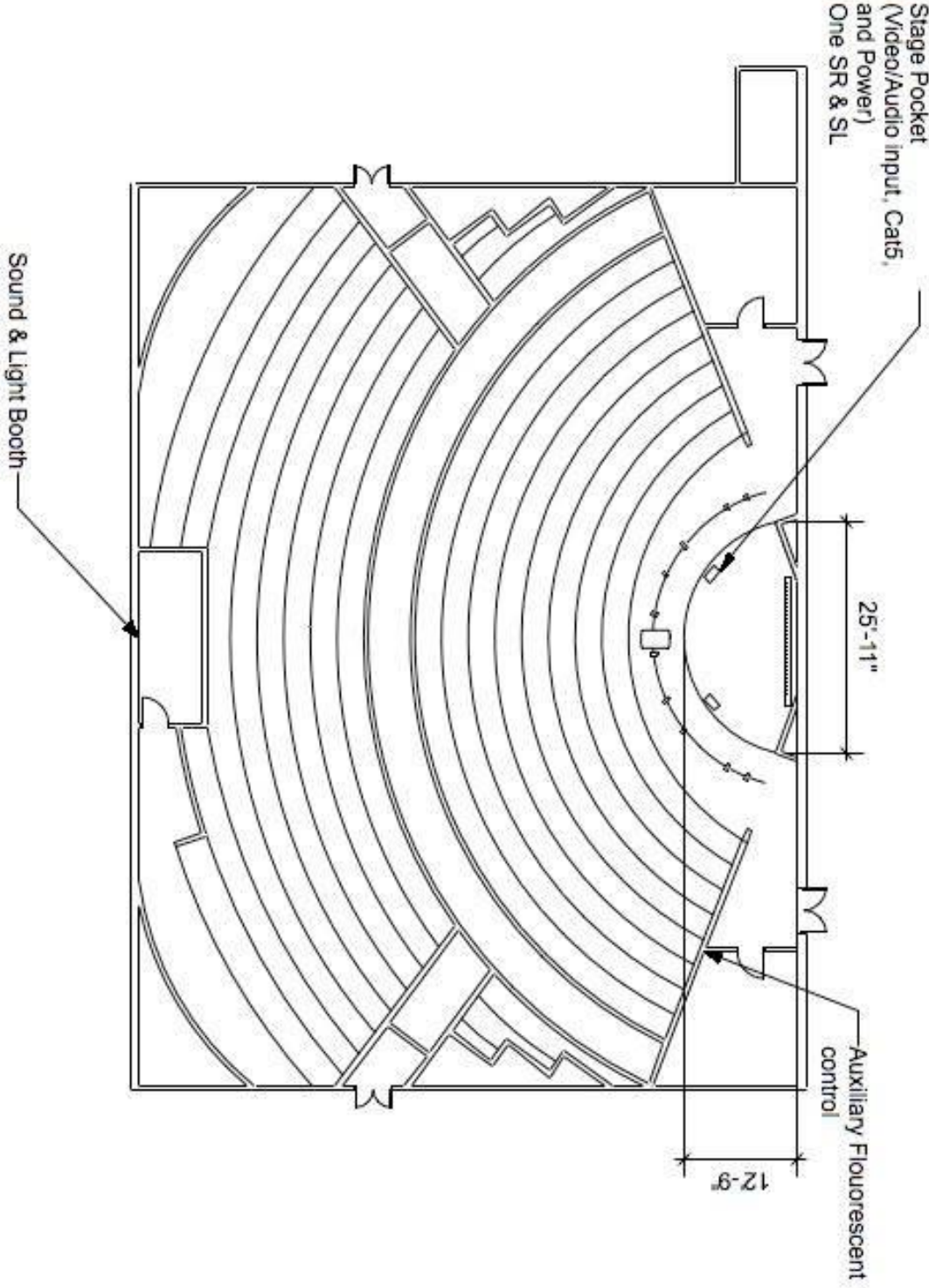

VIRGINIA TECH PRODUCTIONS SERVICES	
COLONIAL HALL	
STAGE LAYOUT	
DRAFTED BY: WEST LIVINGSTON	PLATE: 1 OF 1
DATE: 10/03/17	SCALE: 3/16" = 1'-0"