

TECHNICAL INFORMATION
COMMONWEALTH BALLROOM
VIRGINIA TECH CAMPUS
Office: 540-231-3499 Fax: 540-231-3776
E-Mail: production.services@vt.edu

Virginia Tech does not discriminate against employees, students, or applicants on the basis of race, color, sex, sexual orientation, disability, age, veteran status, national origin, religion, or political affiliation. Anyone having questions concerning discrimination should contact the Equal Opportunity and Affirmative Action Office.

GENERAL INFORMATION

Technical Services:

Technical Services Director
Brian E. James
225 Squires Student Center
Blacksburg, VA 24060
Vox: (540) 231-3499
Fax: (540)231-3776
Email: production.services@vt.edu

Ticket Office:

Ticket Office Manager
Nathan Howe
225 Squires Student Center
Blacksburg, VA 24060
Vox: (540) 231-5615
Fax: (540) 231-5430
Email: articket@vt.edu

Area Hotels:

There are a variety of local hotels, please contact the Presenter for this information.

Taxi Services:

There are a limited number of Taxi Services in the area, please contact the Presenter for this information.

Restaurants:

There is a wide variety of food in walking distance, including fast food, sandwich shops, delis, vegetarian, Chinese and other interests. Please contact the Presenter for more specific information.

Handicapped Access: The Handicapped seating is determined with seating layout.

Emergency Numbers:

All emergency Services: 911
Hospital Emergency Room: (540)953-5122
If additional numbers are needed, please contact the Presenter.

Parking:

- Must be worked out with presenter, generally tour vehicles will not be able to be parked in the loading dock area.

Laundry:

Off site facility, about 1 mile away with coin operated machines.

Directions to Venue:

To reach the campus from Interstate 81 (southbound and northbound):

- Take Exit 118, which has ramps to several different Christiansburg and Blacksburg exits. Take Exit **118B** onto U.S. 460 West; this ramp connects directly to the Christiansburg Bypass. Follow the signs for Blacksburg/Virginia Tech.
- Turn **right** at the stoplight at the intersection of 460W and Southgate Drive.
- Take the **second left** onto Spring Road.
- Take the right onto Washington Street. (You will be at the end of Spring Road.)
- Take the second left onto Kent Road.
- At the top of the hill. Take the first right onto Alumni Mall.
- **Receiving Dock “A” will be dock on your right side.**

Time Zone:

Eastern

MANAGEMENT

Tour Production Office:

There is no Tour Production Office for this Venue. Please speak to presenter to make any needed arrangements.

Green Room:

Located SR with steps and door to stage.
Large mirror and sink
Capacity is 12.

Stage Manager Console:

There are no Stage Manager Consoles.

Rehearsal Rooms:

There are no rehearsal rooms for this venue. Please work out alternate arrangements with the Presenter.

Crew:

Trained student crew and volunteer students.
The Presenter supplies the majority of the labor using volunteer student staff.

Handicapped Access to the Stage:

Must be worked out in advance.

Policies:

- This Venue is a non-smoking venue.
- This is an alcohol free venue.
- There is a performance curfew 30 minutes prior to building close. This varies depending on the day of the week. Please discuss this in the advance.
- The Virginia Tech Police have the authority to be anywhere in the venue at any time.
- Any use of any pyrotechnics, smoke machines, fog machines, open flames or other similar environmental/pyrotechnic effects **must** be approved through the Virginia Tech Environmental Health and Safety Office **in advance**. Contact the local Production Manager to arrange for this.
- Due to local Fire Codes and the nature of the venue fire alarm, the use of pyrotechnics and environmental effects is severely restricted.
- Only venue staff will operate ANY venue owned or installed equipment.
- **THIS IS A NON-SMOKING VENUE**

LOAD-IN AREA

- *Trucks and busses must not block Emergency Service Vehicles Access to the building, or block exits from the building needed for fire egress.*
- Any truck or buss that is left to park in the Loading area, must have a driver that is immediately accessible by phone or radio to move the vehicle incase of an emergency
- Measurements (listed from the exterior of the building moving toward interior)
 - Loading Dock A
 - Truck Height
 - Double Door (x2)
 - 9'-0" high x 8'-0"

CARPENTRY

Seating:

- Before Production Kills, the capacities are:
 - *Full Ballroom: 1939*
 - *Commonwealth A only: empty with no seats 1200*
 - *Commonwealth B only: 684.*
 - *Occupancy down rating will occur for larger set ups or when stage extensions are used.*

Stage Dimensions:

- Full Ballroom approximately 125' L x 100' W
- Commonwealth A approximately 75' L x 106' W
- Commonwealth B approximately 49' L x 95' W

- Stage is 37.5" about ballroom floor.
- Stage is approximately 27' deep x 47' wide divided by curtain.
- Ceiling is sloped from 14' to 7'9"
- Stage can be extended with portable risers by prior arrangement.
- Additional stair units are available by prior arrangement.
- See diagram.

Rigging:

See rigging diagram

Stage – None

House – Girders 1' above ceiling, spaced as shown in rigging diagram

Power:

Stage- 3 phase 400 amp disconnect- 5 wire.

House- Single phase 100 amp disconnect – 4 wire

Stage Floor:

The stage floor is wood-varnished.

Support Areas:

Crossover:

Non available

Storage:

Storage is very limited. Most occurs outside and on the tour trucks. Some storage may be able to happen on the venue floor.

Dressing:

Dressing rooms need to be arranged with the Presenter ahead of time. There are no restrooms that are private available in this venue

Piano:

7' Steinway Grand- tuned A440

Ask for tuning in advance.

This item is always on the stage, and will not be moved

Phone:

There are no phones available for this venue, speak with presenter about any phone or fax needs

Lighting

Architectural-

- 4 zones of dimmable incandescent.
- 2 zones of metal halides.

Stage-

- 12 circuits @ 2.4kw available in lighting cove.
- Controlled by Leprecon 624, or NSI 7016-MPX Protocol
- Standard hang provides 3 color stage and 3 specials.

Sound

- Separable into Ballroom A and Ballroom B
- Ballroom A – 5 speaker cluster (Electro-Voice 1512ER)
- Ballroom B – 8 coaxial ceiling speakers
- Amplifiers and patch bay located in the sound rack in the servery
- Additional portable equipment available upon prior request.

Movie Screen:

Dalite Electro 15'-0" high by 20'-0" wide located 1'0" in front of proscenium wall.

WARDROBE

All Wardrobe issues are between the show and the presenter.

Laundry facilities are off campus, about 1 mile and are coin operated.

No Wardrobe facilities are available in this venue.

All dressing rooms have racks built in, additional portable racks are available if requested prior to show date.

VIRGINIA TECH - SQUIRES STUDENT CENTER - COMMONWEALTH BALLROOM
Information Packet

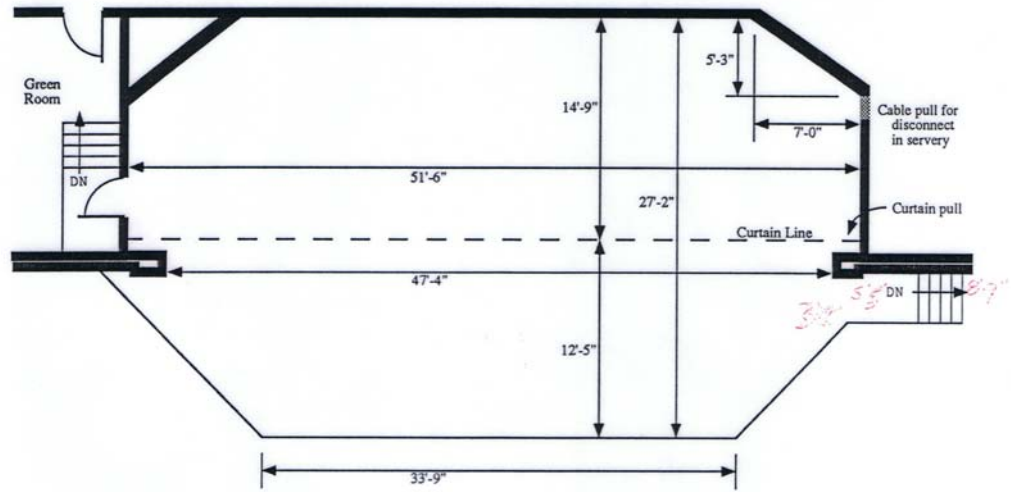

Commonwealth Stage

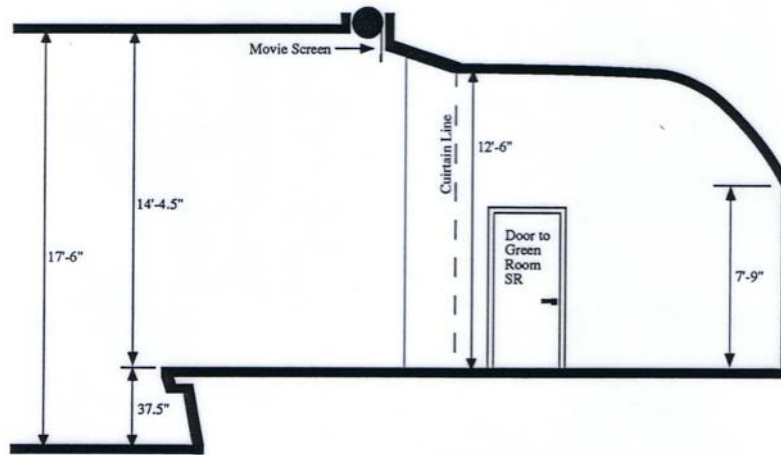

Stage Section

VIRGINIA TECH - SQUIRES STUDENT CENTER - COMMONWEALTH BALLROOM
Information Packet

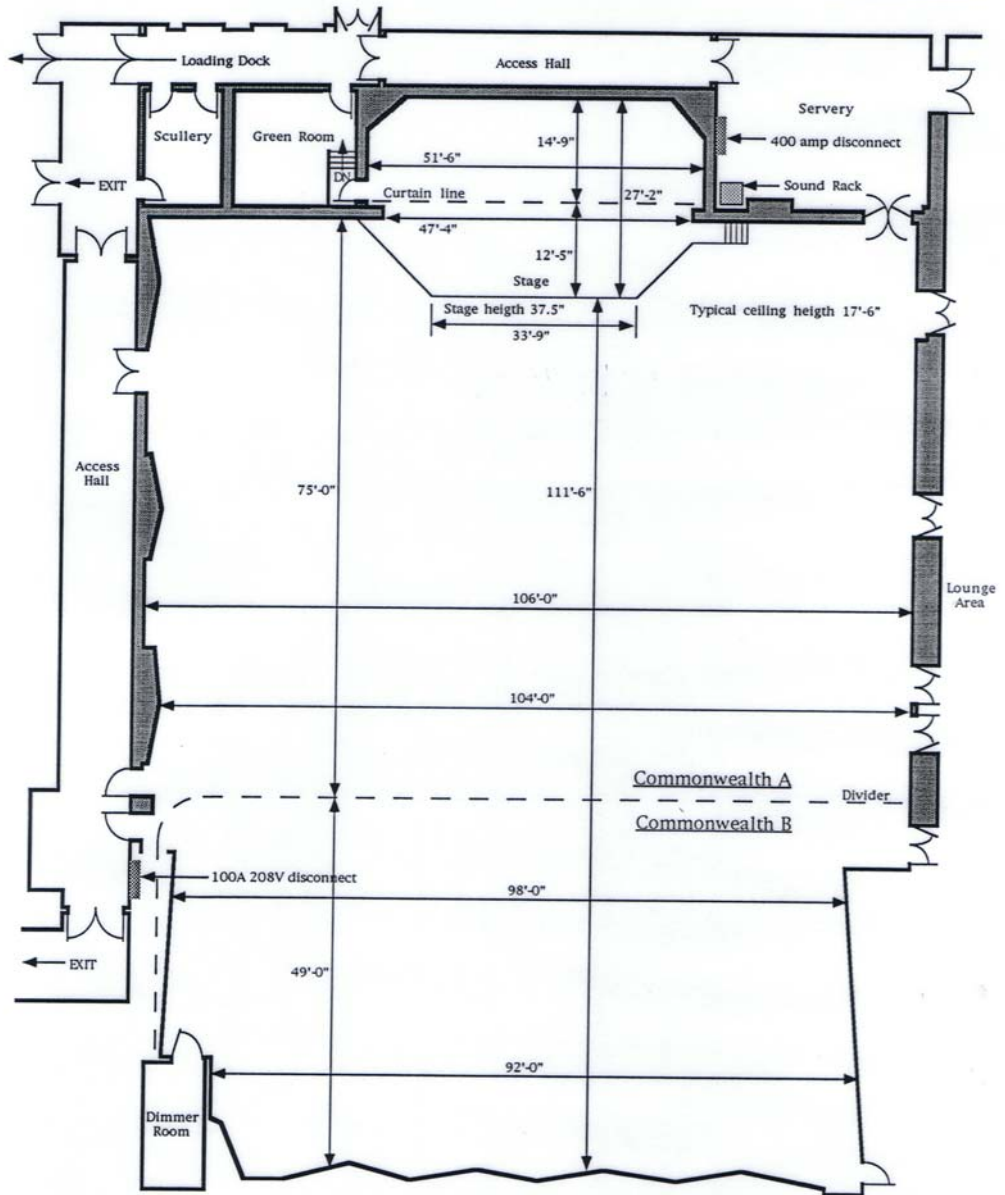

Floor Plan

VIRGINIA TECH - SQUIRES STUDENT CENTER - COMMONWEALTH BALLROOM
Information Packet

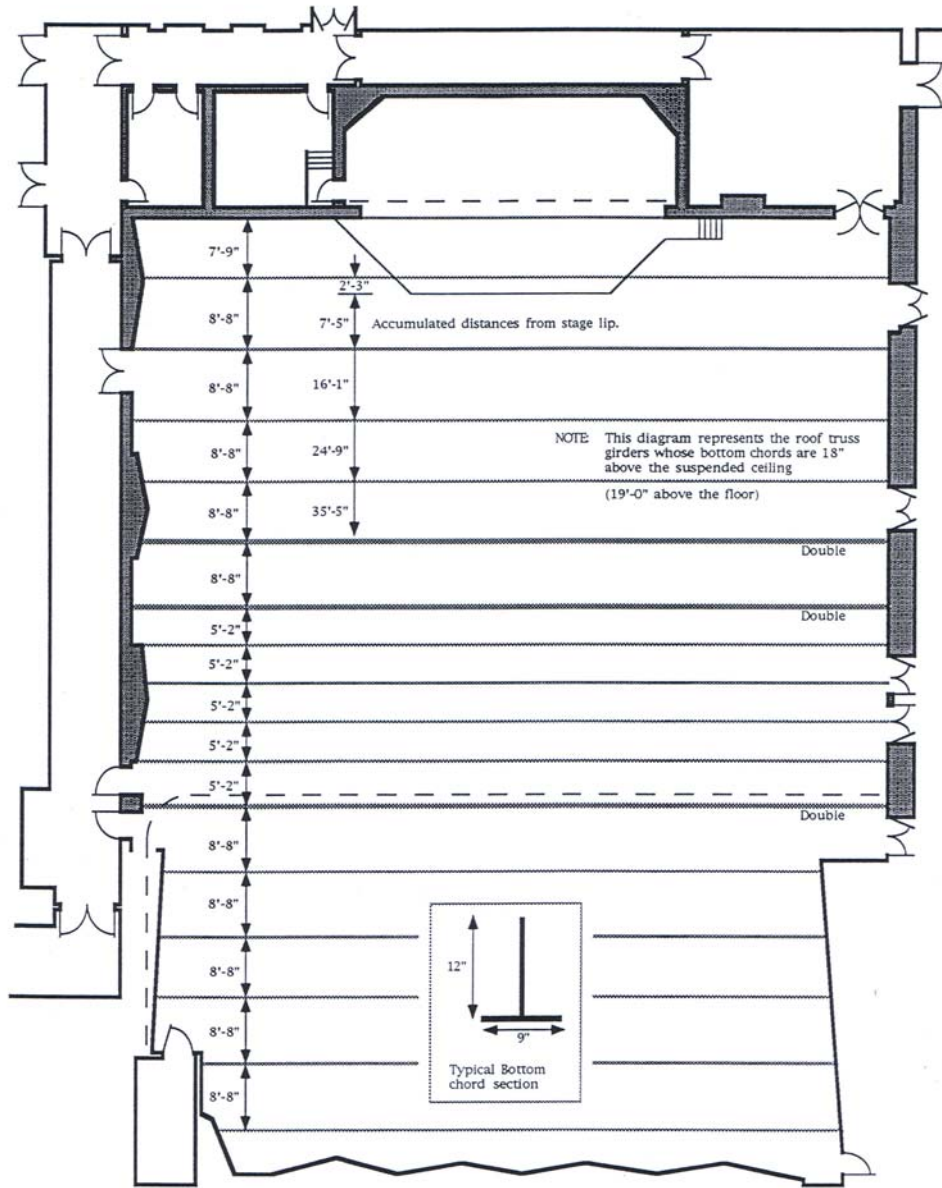

Rigging Diagram

Virginia Tech Used Frequency List

VIRGINIA TECH PHYSICAL PLANT

CH 1 TX 155.985 RX 154.115 71.9 CTCSS	1. PHYSICAL PLANT 1
CH 2 TX 154.115 RX 154.115 71.9 CTCSS	2. PHYS. PLANT 1, T.A.
CH 3 TX 154.650 RX 155.595 97.4 CTCSS	3. PHYSICAL PLANT 2
CH 4 TX 155.595 RX 155.595 97.4 CTCSS	4. PHYS. PLANT 2, T.A.
CH 5 TX 158.130 RX 153.440 162.2 CTCSS	5. UTILITY
CH 6 TX 156.090 RX 155.535 162.2 CTCSS	6. TECH PD
CH 7 TX OPEN RX 155.880 100.0 CTCSS	7. VT/B'BURG RESCUE
CH 8 TX OPEN RX 154.430 100.0 CTCSS	8. B'BURG FIRE
CH 9 TX 156.015 RX 153.920 114.8 CTCSS	9. HOUSING
CH10 TX 158.925 RX 155.115 192.8 CTCSS	10. PARKING SERVICE
CH11 TX OPEN RX 154.725 107.2 CTCSS	11. B'BURG P.D.
CH12 TX OPEN RX 162.475	12. WEATHER
CH13 TX OPEN RX 155.145 100.0 CTCSS	13. B'BURG RESCUE
CH14 TX OPEN RX 155.565 162.2 CTCSS	14. VT/B'BURG P.D.
CH15 TX OPEN RX 159.195 100.0 CTCSS	15. VT RESCUE
CH16 TX 156.090 RX 155.535 192.8 CTCSS	16. TECH PD BACKUP

Campus Wireless Ethernet:

The campus has a wireless ether net system using the 2.4Ghz UNI band. As per IEEE standards 802.11b and G